



Sean E Coogle
Builder

Ofc: 850.932.0378
Fax: 850.934.9955
coogle@cooglehomes.com

RG291103750 RR0067113 *Serving NW Florida Since 1986*

Insulated Concrete Forms * High Hurricane Resistant
Piling Homes * Wood Frame Homes * All Types Siding

www.CoogleHomes.com

Pearl

1262 Sq. Ft.
3 Beds 2 Baths

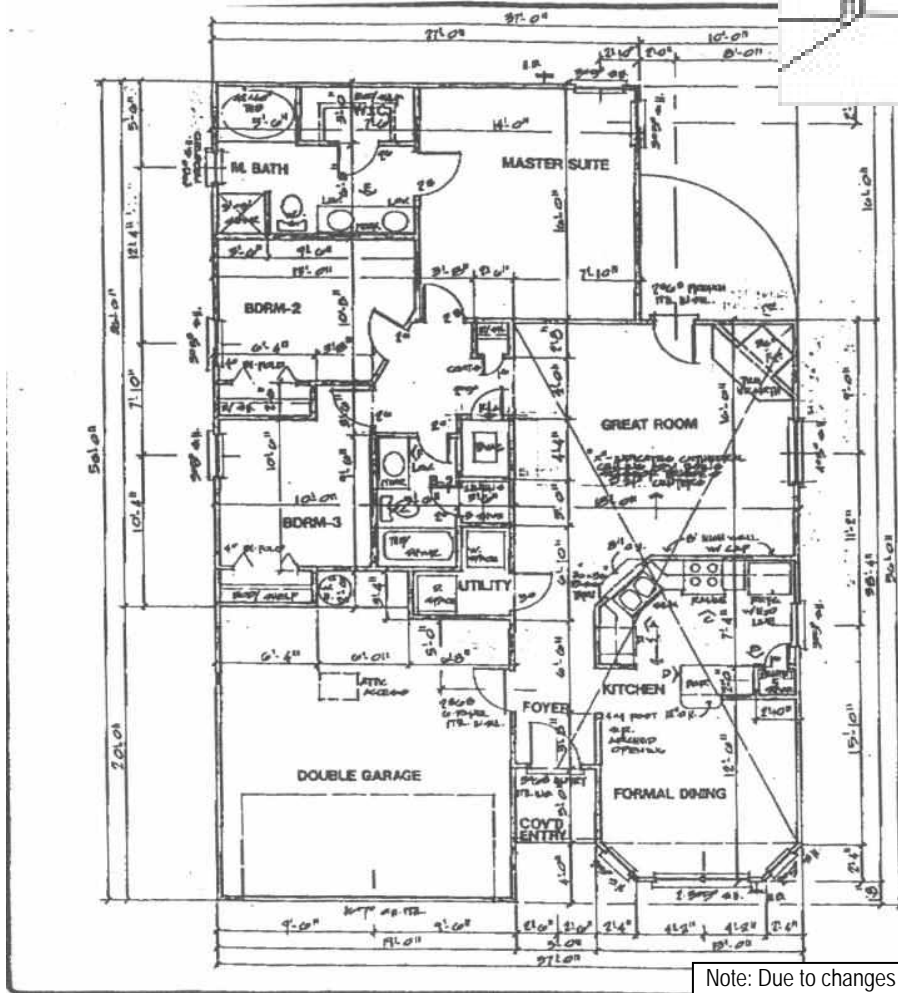

AREAS:
LIVING AREA: 1453 S.F.
DOUBLE GARAGE: 387 S.F.
COVD ENTRY: 25 S.F.

NOTE:
OWNER'S PROPERTY, NOT ASSURED BY LIABILITY FROM
ANY CONTRACTOR OR SUBCONTRACTOR. THIS PLAN IS
FOR INFORMATION ONLY AND IS NOT A CONTRACT. ALL
DIMENSIONS AND SPECIFICATIONS ARE SUBJECT TO
CHANGE WITHOUT NOTICE. THE OWNER ACCEPTS
ALL RESPONSIBILITY FOR THE ACCURACY OF THIS PLAN.
NO WARRANTIES ARE MADE BY THE ARCHITECT.

Note: Due to changes in building codes and product availability we reserve the right to change prices, plans and specifications without notice.

TeamBraddyandCoogle.com
Synergy Selling NW Florida Real Estate

Julia Braddy
850-686-2963

Lorie Coogle
850-554-6678

31 Hoffman Dr
Gulf Breeze, FL 32561

If your property is currently listed with a real estate broker, please disregard. It is not our intention to solicit the offerings of other real estate brokers. We are happy to work with them and cooperate fully. *The information in this brochure is deemed reliable but not guaranteed.*